

ROMAN®

Sculptures

Recess In-Line Hinged Door Enclosure Instruction Manual

Use
ROMAN
ULTRA CARE
- multi-purpose glass protector on
this product for a long
lasting sparkle.
(See inside for information)



Truelife Consumer Guarantee

Please make sure the purchaser/end user completes and returns the Guarantee card which is enclosed with this product or registers on line at www.roman-showers.com/register_guarantee.htm. Failure to validate the Roman Truelife Guarantee will mean only the 1 Year Statutory Guarantee will apply.

PRODUCT CODE REF:

IMPORTANT

- Please ensure the consumer guarantee card enclosed with this product is completed and returned to Roman; please ensure the end user retains this manual.
- Please read all instructions carefully before attempting installation.
- Handle the product with care to avoid damage to the product finish.
- Check for hidden electrical cables and water pipes prior to commencing any drilling work.
- Images are used for illustration purposes only, product designs may differ slightly as a result of continuing product development.
- Roman Sculptures enclosures are heavy, this enclosure installation must be carried out by a minimum of two people to avoid possible lifting injury and damage to the large glass panels.

Component Check List: Supplied

Description	Quantity
Plain Panel	1
Door	1
Hinged Panel	1
Wall Profile Sub-Assembly	2
Roman Branding Clip	1
Straight Hinge	2
Handle	1
25mm Brace Bar	1
180° Seal for 10mm Glass	4
Drip Rail for 10mm Glass	1
Brace Bar Wall Joint	2

Equipment Check List: Not Supplied

Description

PZ2 Pozidrive Screwdriver
Bathroom Sealant Gun
Spirit level (large)
Drill and 6mm Masonry Bit
Tape Measure
Pencil
Allen Keys (supplied)
Torque Wrench

N.B. Torque Wrench must be used to tighten the Allen bolts to 10N/m on the door hinges, as indicated in the door installation instructions.

Installation Site Preparation - Site Preparation

Walls

The walls to which the enclosure is to be fitted to must be vertical with no more than 5mm deviation. A maximum of 5mm adjustment is provided within the enclosure to take account for untrue walls.

Tray

If fitting to a tray the following requirements must be met before installation can commence:

- The tray must be a Roman product.
- The tray must be fitted according to the Roman instruction manual supplied with the tray.
- Any tiling of the walls **must not** overhang the tray by more than 5mm. The tray can be offset from the wall to achieve this, see image below.
- Any tiling and sealing around the tray and enclosure area must be completed and fully dry.

Wetroom Installation

For wet room Installation an F20 glass / floor protector is recommended. Please contact customer services on 01325 328034 to request your pack.

Before Assembly and Installation of the Sculptures Recess In-Line Hinged Door Enclosure

- Check that you have the correct size enclosure for your tray if fitting to tray. This can be done by referring to the label on the side of the product packaging. Once the installation has commenced the installer becomes liable for any rectification costs due to incorrect specification of product at the point of order.
- Inspect the product for defects. Installation queries on damaged parts cannot be resolved once the installation has been completed.
- If used, the tray must be completely sealed along tiled walls, fitted completely level (check with a spirit level) and should have no leaks prior to commencing the installation. Also ensure that the walls where the enclosure is to be fitted are vertical, this can be done using a spirit level.
- A maximum of 5mm of adjustment is provided in the wall profile.
- It is recommended that the wall profiles are fitted directly onto tiles or a similar sealed surface.
- Ensure all the parts are in the packaging by checking them against the parts and quantities shown on the next page.
- Once the installation has commenced the installer becomes liable for any rectification costs due to incorrect specification of product or fitting of tray.

ITEM NO.	DESCRIPTION	QUANTITY
1	Plain Panel	1
2	Door	1
3	Hinge Panel	1
4	Wall Profile Sub-Assembly	2
5	Roman Clip	1
7	Straight Hinge	2
8	Handle	1
9	25mm Brace Bar	1
10	180° Seal for 10mm Glass	1
11	180° Seal for 10mm Glass	2
12	180° Seal for 10mm Glass	1
13	Deflector Seal	1
14	Brace Bar Wall Joint	2

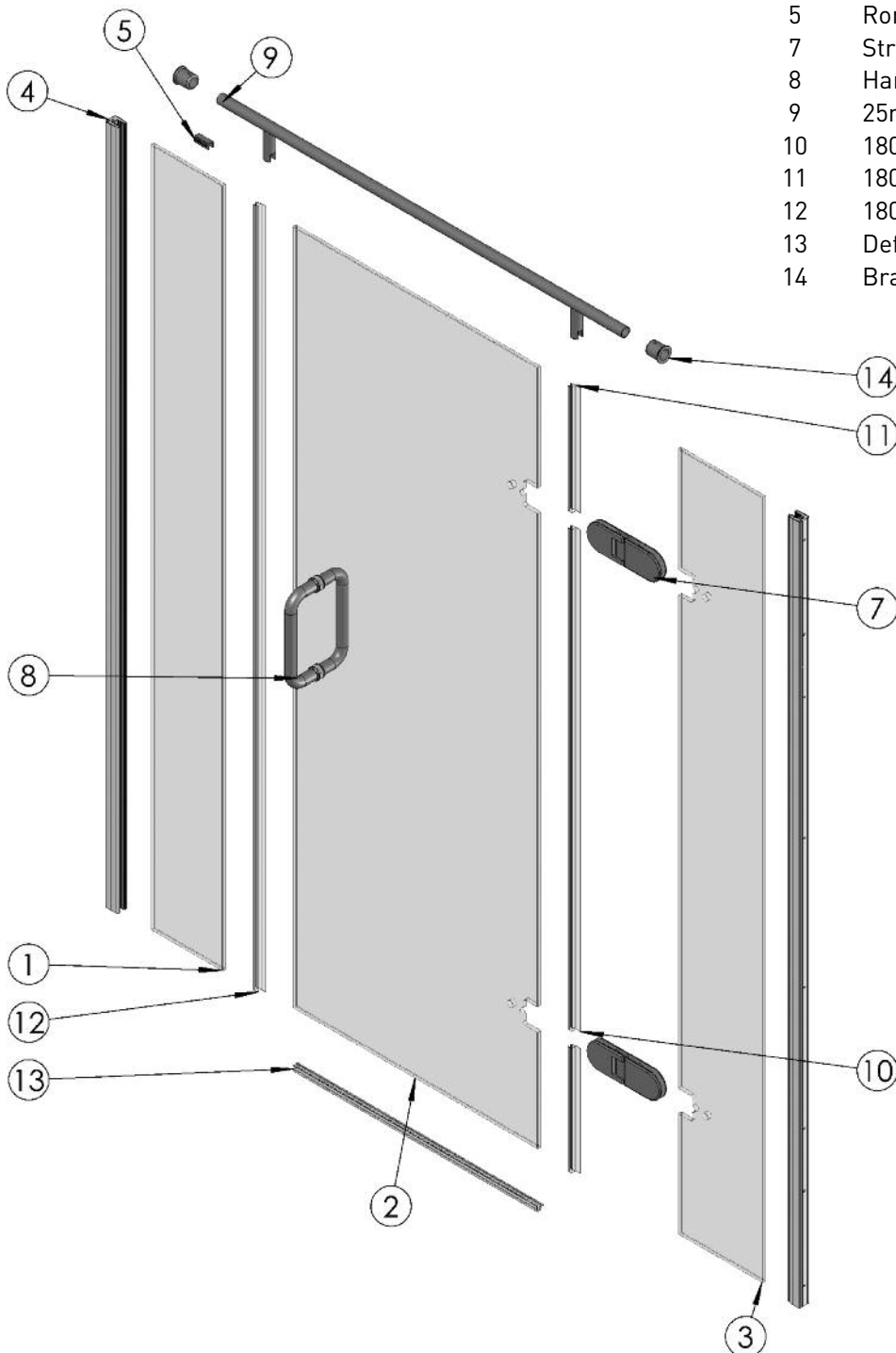

Installation Site Preparation

Site Requirements

This Roman enclosure is designed to fit into a alcove between two walls (**Diagram A**). Each size of enclosure has a minimum and maximum width, this is shown in the table below.

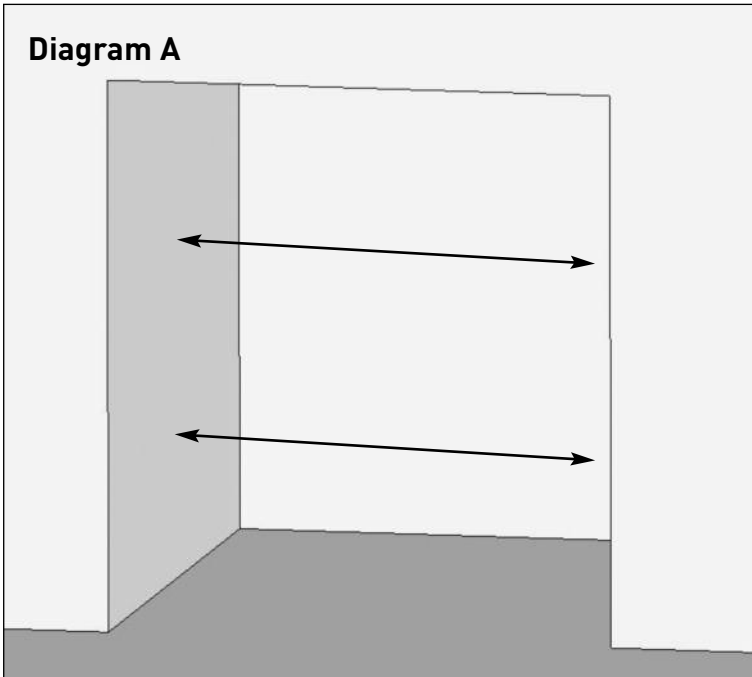

Enclosure size	Minimum alcove size	Maximum alcove size
----------------	---------------------	---------------------

1200	1180	1200
1400	1380	1400
1600	1580	1600

Note: The above dimensions include any tiling.

Panel Installation Tray and Wetroom

Items Required

	Item No.	Qty
Glass Hinge Panel & Plain Panel	1, 3	2
Wall Profile Assembly	4	2

Tools: Drill, 6mm Masonry bit, Spirit Level, Pencil, Tape Measure

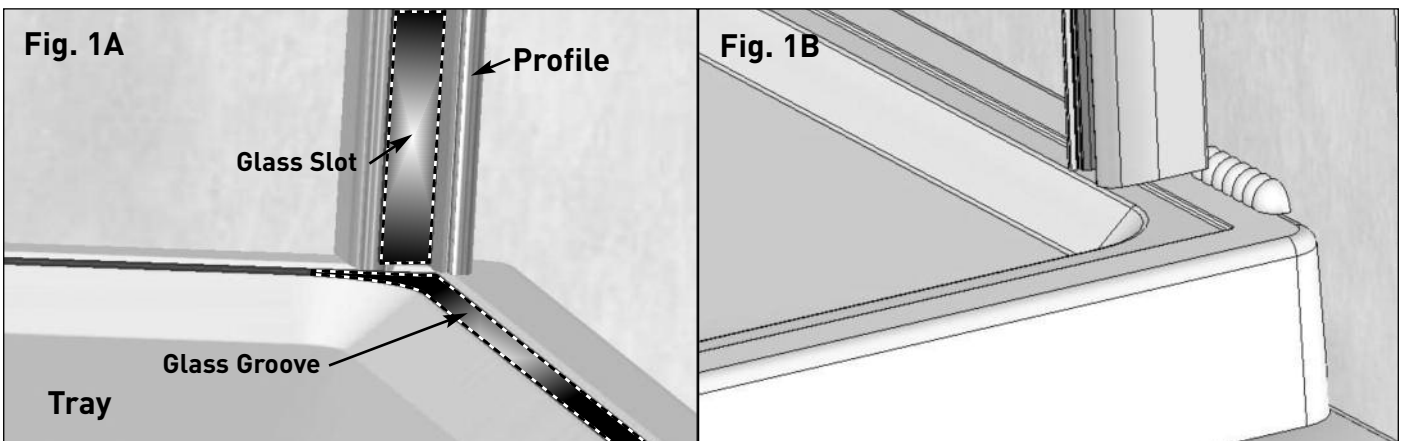

- Fit the wall profile assemblies using the screws and wall plugs supplied in the wall profile assembly, ensuring the following:
 - If fitting to a tray the glass slot in the profile is fitted in line with the glass groove in the tray, both of which are shown in image (**Fig. 1A**).
 - The screws down the sides of the wall profile assemblies face towards the centre of the enclosure.
 - The wall profile is fitted completely vertical (this is checked using the spirit level)
 - A bead of sealant is placed between the tiled wall and the tray top / floor where the profile assembly is to be fitted (**Fig. 1B**).

Note: no sealant should be placed between the wall profile and the tiled wall before screw fixing.

Front Panel Installation

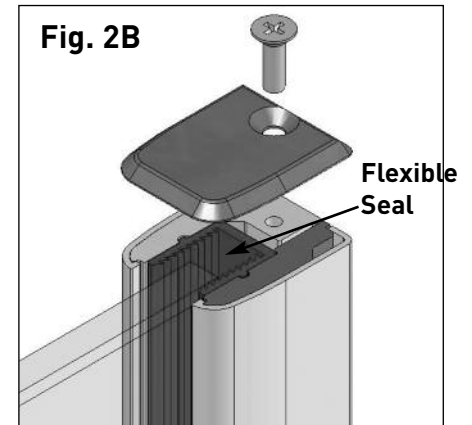
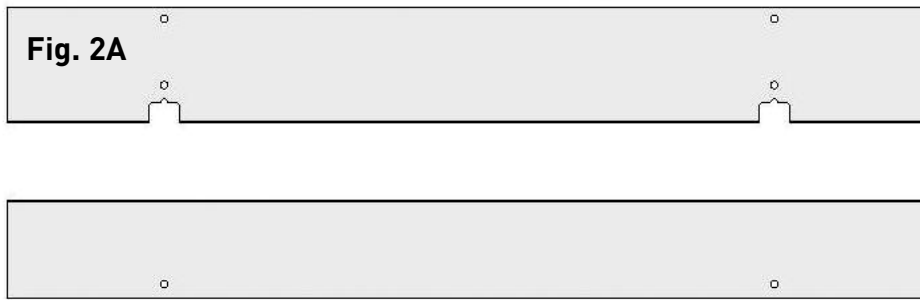

2.
 - Choose which side the door is to open towards and fit hinge panel on that side. See above (Fig. 2A)
 - Loosen the screws down the side of the wall profile assemblies by 3 turns.
 - Insert flexible clear seal supplied with the assembly onto the glass edge.
 - If fitting to the tray check to ensure the glass groove in the tray is free from debris as this would stop the glass from sitting flat.

3.
 - Ensure that the cut outs in the hinge panel are towards the centre of the enclosure. Lift the glass panel onto the glass groove on tray, if fitting and push into profile.
 - Repeat process with other panel.
 - Measure the gap between the panels at the top and bottom and adjust position until it is between 705-710mm ensuring that at least 5mm of the panels are inserted into the wall profiles (Fig. 3B).
 - When you are happy with the panel position, push the excess clear seal into the profile away from view (Fig. 2B)
 - Tighten the screws in wall profile assembly with an Allen key to secure the glass panels and fix the top caps to the top of the profile assemblies using screws supplied. (Fig. 2B)

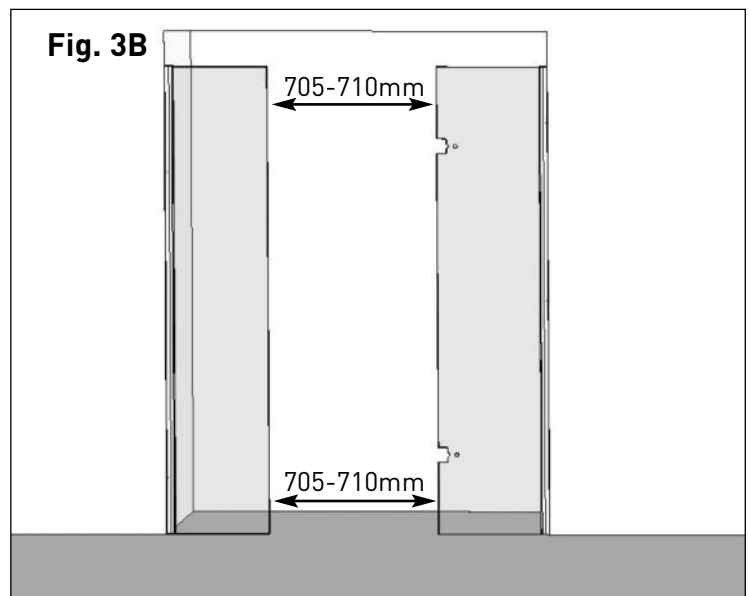

Brace Bar Installation

Items Required	Item No.	Qty
Large Brace bar assembly	9	1
Brace bar wall joint	14	2

Tools: Allen Keys (Supplied), Pencil, Tape Measure, Drill, 6mm Masonry Bit

4.
 - Measure and drill a hole in the wall directly above the wall profile assemblies at a distance of 57mm from the top of the profiles (Fig. 4A).
 - Remove the centre section from the brace bar wall joints and fix them to the wall using the screws supplied, ensuring that the slot in the wall joint is vertical as shown in (Fig. 4A).

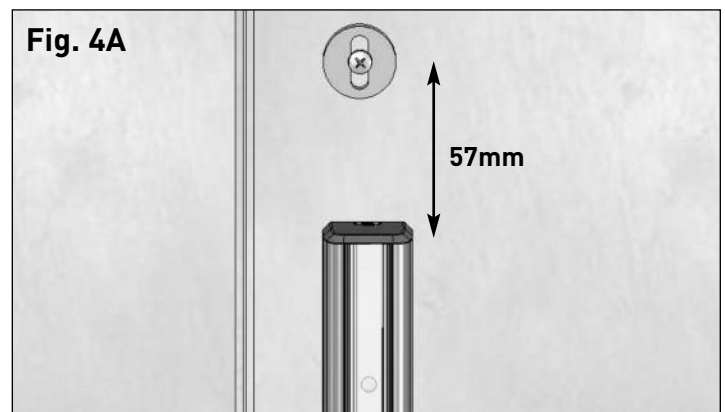

5. ■ Slide the wall joints over the bracing bar as far as possible as shown above ensuring that the flat side of the wall joints face outwards (**Fig. 5A**).
- Fit the bracing bar ensuring that the glass joints sit over the glass panels.
- Screw the wall joints onto the centre sections, which were screwed onto the wall and tighten the allen bolts to secure the brace bar into position (**Fig. 5B**).

Fig. 5A



Fig. 5B



Door Installation

Items Required	Item No.	Qty
Glass Door	2	1
Door Hinge Pack	7	2
Deflector Seal	13	1
Handle Assembly	8	1

Tools: Allen Keys (Supplied), Torque Wrench (not supplied).

Note: Prior to installing the door you may wish to jump to point 9 and install the handle. This may help you to lift the door during the installation.

Fig. 6A

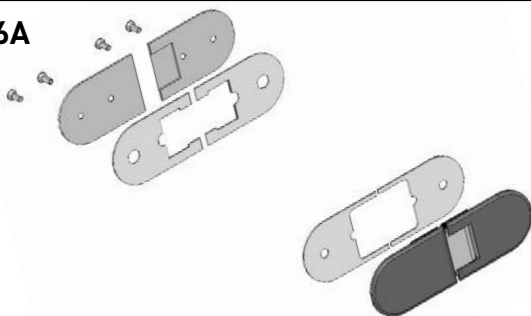

Fig. 6B

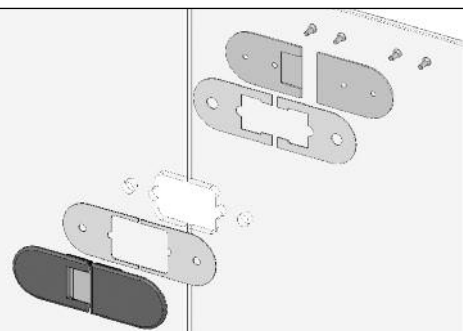

Fig. 6C

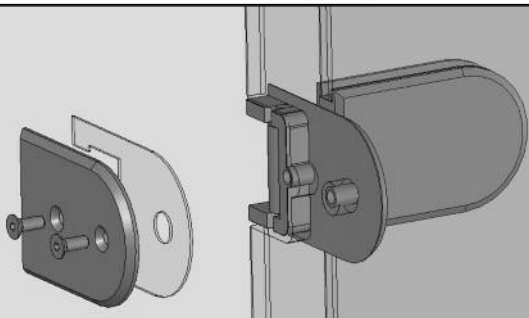
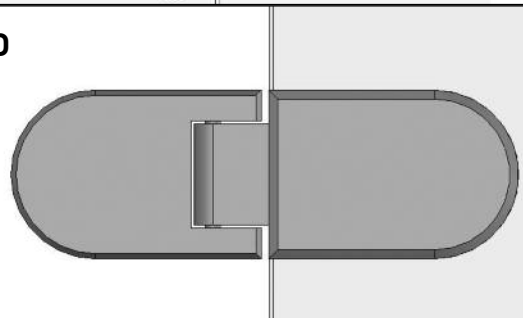
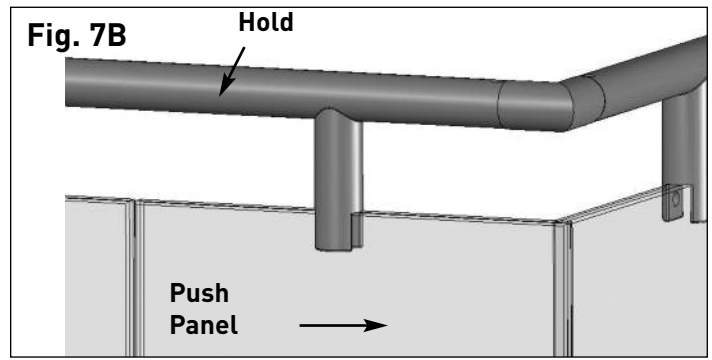
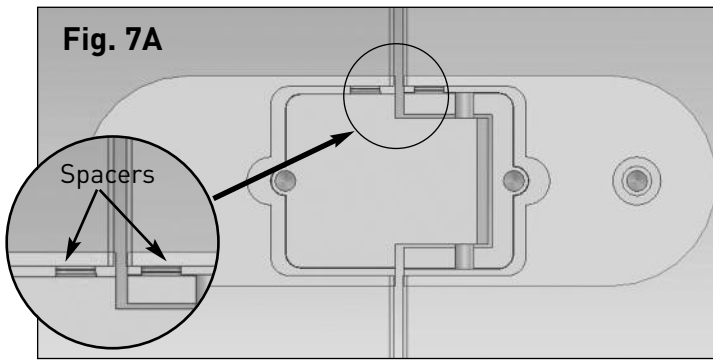

Fig. 6D



6. ■ Remove Allen bolts, back plates and all the clear spacers from the hinge assemblies (**Fig 6A**).
- When re-assembling the hinges ensure the clear spacers are placed between the glass and the metal of the hinge (**Fig 6B**).
- Pay particular attention to the order of the clear spacers when assembling the hinge, there are two spacers per side, one small and one large.
- At the front of the hinge there is a small clear spacer between the glass and the metal of the hinge per side.
- At the rear of the hinge there is a larger clear spacer between the glass and hinge backplate.
- Pay particular attention when re-assembling the hinge to ensure that correct backplate goes onto the correct side of the hinge (**Fig. 6B**).
- Re-assemble the fixed side of the hinge to the fixed panel (**Fig 6D**).
- Check the smooth surface of the hinges face out of the enclosure (**Fig 6D**).
- Check the hinges are fitted level with the edge of the glass (**Fig 6D**).
- Check the pivot side of the hinges face towards the centre of the enclosure (**Fig 6D**).
- Open the hinges outward, so they sit at 90 degrees to the glass panel (**Fig 6C**).
- Check the door glass is the correct way before fitting. The door should hang with a gap of approximately 8mm between the bottom of the door and the tray. This is to allow the fitting of the drip rail later.
- To hang the door, line up the cut outs in the glass to the hinges. (Make sure one small spacer is in between the glass and the hinge at the front of the door).
- When the door is correctly located, assemble the spacers and the hinge back plates.
- When the door and the hinges have been assembled, all the Allen bolts of the hinge must be tightened to 10 N/m with a Torque wrench.



7. Once the door is fitted it may need aligning using the steps below.
- Loosen the bolts on the door side of the hinge where it needs re-aligning.
 - Gently push the door into new position.
 - N.B.** ■ If necessary PVC 10 X 8mm spacers can be placed between the hinge and the glass as shown in **Fig. 7A**.
 - Between 1 and 3 spacers per side can be fitted depending on the size of the gap between the hinge and the glass.
 - To fit the spacers loosen the Allen bolts and remove the back plates and clear plastic spacers. Lift the glass. Insert the PVC 10 X 8mm spacers as required see **Fig. 7A**.
 - Re-assemble the hinge and tighten the Allen bolts to 10N/m.

If the door still does not hang straight or close, some adjustment can be gained from the glass panels and the bracing (brace bar can be seen in **Fig. 7B**).

- Loosen grub screws in the bracing that clamps to the glass.
- Push the glass panels to achieve the desired gap for the door.
- Re-tighten the brace bars to the glass.

8. When the door is fully aligned, fit the seals as described below.
- Fit the 3 smaller lengths of seal to the glass door on the hinge side, ensuring that the flexible edge of the seal (**Fig. 8A**) is towards the inside of the enclosure.
 - Fit the long length of seal on the plain front panel, ensuring that the flexible edge of the seal faces towards the inside of the enclosure.

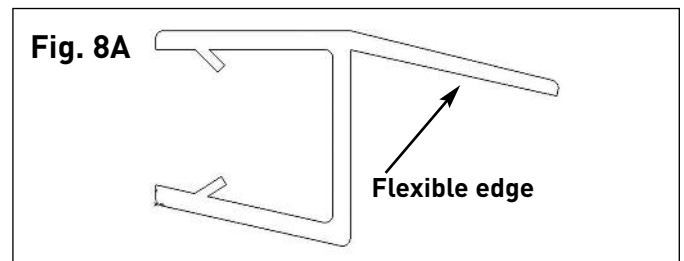

IMPORTANT: All the vertical and horizontal seals must be cut square and to the correct length to ensure the enclosure is water tight, using a Stanley knife or an alternative blade.

9. ■ Remove the handle from packaging, loosen grub screws using the allen key supplied and split handle.
- Dismantle and re-assemble handle on door as shown in (**Fig. 9A**) ensuring that the side with the allen bolts faces inside the enclosure.

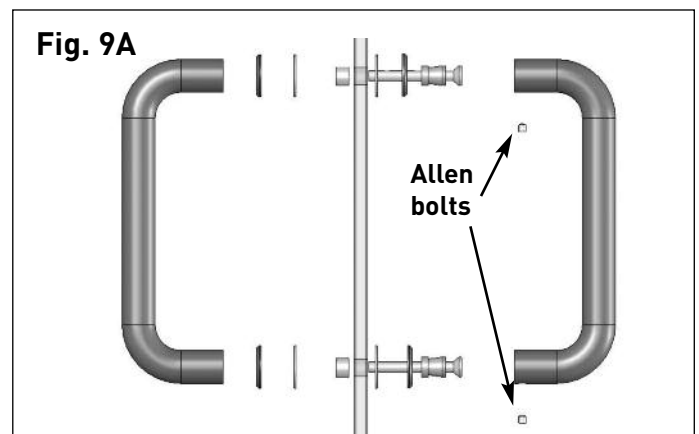

10. ■ Push the deflector seal onto the bottom of the door ensuring that the curved deflector faces towards the inside of the enclosure (**Fig. 10A**).

IMPORTANT: All the vertical and horizontal seals must be cut square and to the correct length to ensure the enclosure is water tight, using a Stanley knife or an alternative blade.

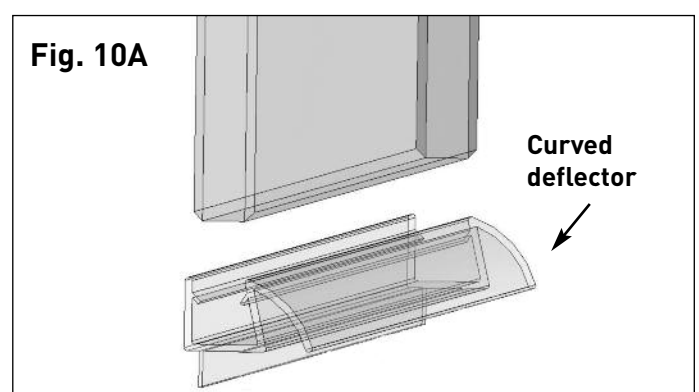

11. ■ Once all the assembly steps are completed and all Allen bolts are fully tightened. Seal the outside of the enclosure only, using the supplied Otto Seal S50 sealant following the steps below.
- Ensure sealant bead is less than 3mm, this ensures that the sealant dries clear.
 - Seal the joint between the glass panels and the tray and the wall profiles and the tiles around the outside of the enclosure as shown in image (Fig. 11A).

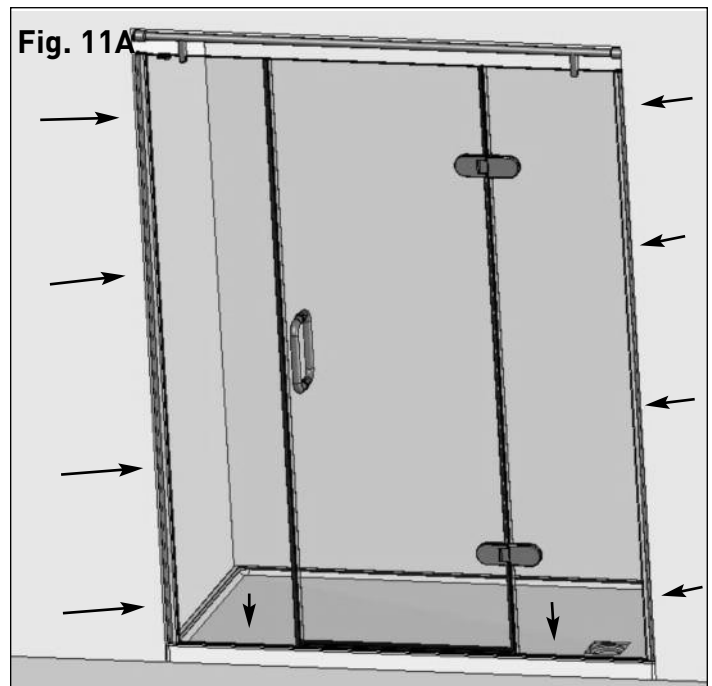

12. ■ Ensure the Roman Branding Clip is fixed to the top of one of the fixed glass panels with a small amount of sealant (Fig. 12A).



Should you experience any problems during installation please refer to the Trouble Shooting Guide on back page or contact Roman Customer Services on: 01325 328034.

To enable Customer Services to provide you with an excellent level of service it is important that you quote your Product Code and Reference Number - these numbers can be found on the front of your Instruction Manual

Maintaining Your Enclosure

DO NOT use acidic based descaler products or products which are unsuitable for cleaning enamel surfaces, including abrasive cleaners or cleaners containing bleach or solvents, as these products will affect both the anodised and coated framework.

NEVER use scouring powder or pads or sharp instruments when cleaning the enclosure.

Roman Shower Enclosures and Bath Screens are designed for luxury showering and with care and attention you can keep them looking new for longer by using the strongly recommended **Roman Ultra Care** (see back page), the multi-purpose glass protector after cleaning. Alternatively, occasionally wipe your Roman Shower Enclosure with a mild detergent diluted with water and polish with a soft cloth. If you live in a hard water area, periodically clean with a 50/50 solution of white vinegar and soak for five minutes and remove any limescale residue by rinsing with warm water. Periodically clean the seals of your Enclosure with an anti-bacterial spray. This is all you require to keep the glass, seals and coated / anodised aluminium parts looking new.

SCULPTURES TROUBLE SHOOTING GUIDE.

Problem

Solution

DOOR DROPPING

1. Check the clear PVC 10 X 8mm spacers have been placed between the hinge and the glass.
2. Between 1 and 3 spacers per side can be fitted depending on the size of the gap between the hinge and the glass.
3. To fit the spacers loosen the Allen bolts and remove the back plates and clear plastic spacers.
Insert the spacers as required.
4. Re-assemble the hinge and tighten the Allen bolts to 10 N/m.
5. Check that all fixings on the enclosure are sufficiently tight to fully strengthen enclosure.
6. Check that the brace bar has been fitted correctly and all the grub screws and clamps have been sufficiently tightened.

LEAKING

1. Check all the vertical and horizontal door seals have been cut correctly.
2. Check that sealant has been applied between the tiled wall, the tray and the the bottom of the wall profiles.
3. Check the out side of the enclosure has been sealed between the wall profiles and tiles.
4. Check the out side of the enclosure has been sealed between the tray and the enclosure.
5. Check the out side of the enclosure has been sealed between any fixed glass panels.
6. Check the gaskets in the hinges have been assembled in the correct order.

ENCLOSURE ALIGNMENT ON TRAY

1. Check that the wall profiles are completely square.
2. Check the wall profiles have been installed in the correct position.
3. Check the tray has been installed correctly (refer to the tray installation instructions).
4. Check the walls which the enclosure is to be fitted are vertical with no more than 5mm deviation.
5. Check the brace bar has been fitted correctly and all the grub screws and clamps have been sufficiently tightened.

PANEL MOVING

1. Check the glass is sitting in the gasket and wall profile channel sufficiently for the grub screws to grip and hold the glass.

Important

The walls which the enclosure is to be fitted to must be vertical with no more than 5mm deviation. A maximum of 5mm adjustment is provided within the enclosure to take account for untrue walls.

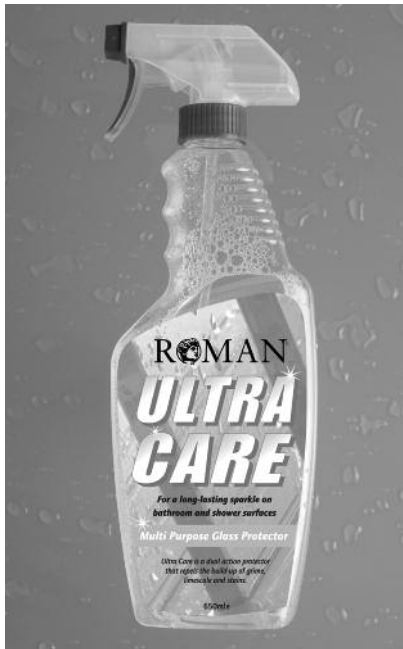

Ultra Care

THE MORE YOU SPRAY – THE MORE YOU PROTECT.

Roman Ultra Care is a product from Roman designed to give all your shower and bathroom surfaces a long-lasting sparkle. The benefit of Ultra Care is the more you spray, the more you protect.

Ultra Care is a multi-purpose glass protector that repels the build-up of grime, limescale and stains.

Roman Ultra Care was developed for Roman shower enclosures and screens. It is a unique and effective non-filming formula for all glass surfaces, tiles, shower seals and aluminium frames, taps, trays and baths.

Why not try it on your car windscreen!

For your nearest stockist please call +44 (0) 1325 328034

ROMAN LIMITED, WHITWORTH AVENUE, AYCLIFFE INDUSTRIAL PARK, COUNTY DURHAM, DL5 6YN, ENGLAND, UK.

Member of

GENERAL RECEPTION: PHONE +44 (0) 1325 311318 FAX +44 (0) 1325 319889

CUSTOMER SERVICES: PHONE +44 (0) 1325 328034 FAX +44 (0) 1325 328031

SALES ENQUIRIES: PHONE +44 (0) 1325 328033 FAX +44 (0) 1325 328027

www.roman-showers.com

